

0020.010.038
JEH/crd
08/13/91

ORDINANCE NO. 1648

ORIGINAL

AN ORDINANCE OF THE CITY OF REDMOND, WASHINGTON,
ANNEXING A PORTION OF THE AVONDALE ROAD RIGHT-OF-
WAY NORTH OF N.E. 106TH STREET.

WHEREAS, the City of Redmond's eastern boundary north of N.E. 106th Street is the west line of the Avondale Road right-of-way, and

WHEREAS, the City Council has determined that it would be in the best interests of the City to assume jurisdiction over Avondale Road and extend the City's eastern boundary to the east right-of-way line, and

WHEREAS, RCW 35.21.790 permits the governing bodies of counties and cities to revise, by agreement, any part of the corporate boundary of the city which coincides with the edge of a public street or right-of-way, and provides that such boundary revision becomes effective when approved by ordinance of the City Council and by ordinance or resolution of the County Council, and

WHEREAS, King County has passed an ordinance approving the annexation and boundary revision and requesting that the City do the same, now, therefore,

THE CITY COUNCIL OF THE CITY OF REDMOND, WASHINGTON,
HEREBY ORDAINS AS FOLLOWS:

Section 1. Annexation and Boundary Revision. Pursuant to RCW 35.21.790, the corporate boundary of the City of Redmond is hereby revised to include the right-of-way legally described on Exhibit A attached hereto and incorporated herein by this

reference as if set forth in full, and to annex the same to the City.

Section 2. Improvements to Right-of-Way. This ordinance is passed by the City in express reliance upon the provisions of County Ordinance No. 91-661 concerning the County's commitment and agreement to improve the right-of-way as part of a larger improvement of Avondale Road. The City hereby accepts the offer of King County contained in the said County ordinance, with the intent that said obligation shall become binding upon the County immediately upon passage of this ordinance.

Section 3. Severability. If any section, sentence, clause or phrase of this ordinance should be held to be invalid or unconstitutional by a court of competent jurisdiction, such invalidity or unconstitutionality shall not affect the validity or constitutionality of any other section, sentence, clause or phrase of this ordinance.

Section 4. Effective Date. This ordinance, being an exercise of a power specifically delegated to the City legislative body, is not subject to referendum, and shall take effect five (5) days after passage and publication of the ordinance or a summary thereof consisting of the title.

APPROVED:

MAYOR, DOREEN MARCHIONE

ATTEST/AUTHENTICATED:

CITY CLERK, DORIS SCHAIBLE

APPROVED AS TO FORM:
OFFICE OF THE CITY ATTORNEY:

BY *Theresa A. Ryan Foster*

FILED WITH THE CITY CLERK: 8/15/91
PASSED BY THE CITY COUNCIL: 9/10/91
PUBLISHED: 9/15/91
EFFECTIVE DATE: 9/20/91
ORDINANCE NO. 1648

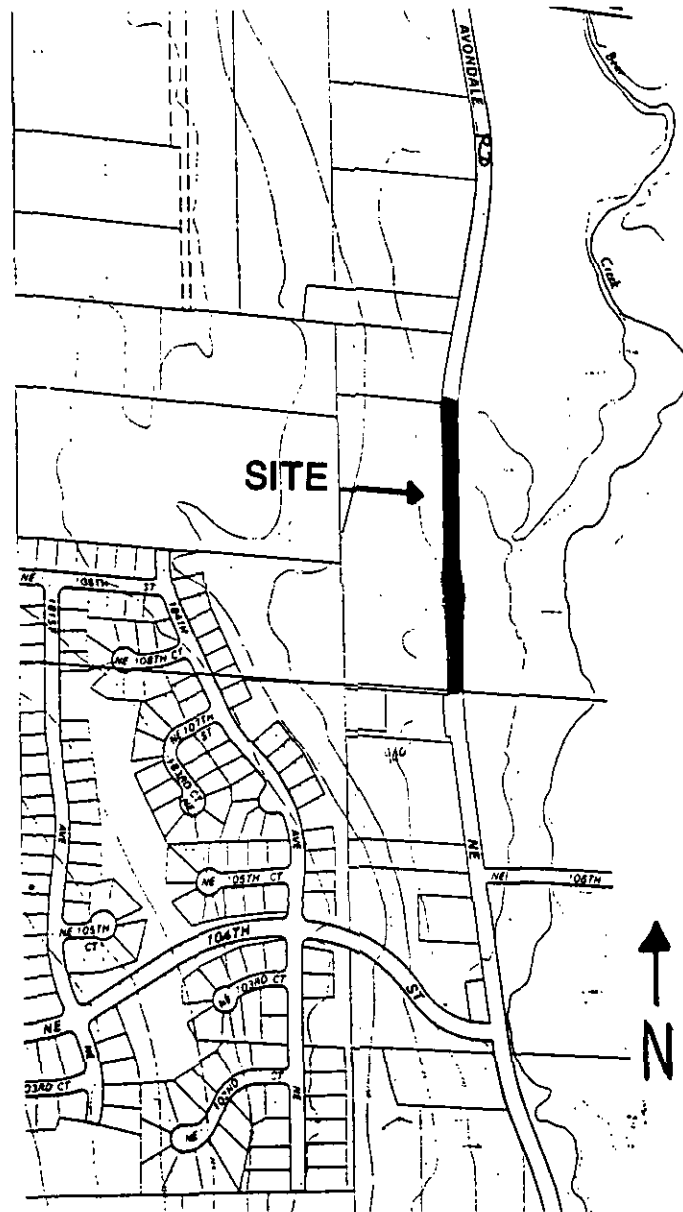

That portion of the Southeast quarter of the Northwest quarter of Section 31, Township 26 North, Range 6 East, W.M., King County, Washington, described as follows:

All of Avondale Road N.E. lying within said subdivision EXCEPT the North 250 feet thereof, said portion of roadway lies Easterly of that area described in Redmond Ordinance 1577 as annexed to said City.

Avondale Road right-of-way north of N.E. 106 Street
September 10, 1991
Ordinance No. 1648