

0020.200.031
JEH/are
11/23/93

ANN91-003 Annexation
SE Redmond Storage Tank
Site

ORDINANCE NO. 1766

ORIGINAL

AN ORDINANCE OF THE CITY OF REDMOND,
WASHINGTON, ANNEXING CERTAIN PROPERTY COMMONLY
KNOWN AS THE SOUTHEAST REDMOND STORAGE TANK
SITE FOR MUNICIPAL PURPOSES, CITY FILE NO.
ANN-91-0003.

WHEREAS, the City has acquired, through condemnation, certain property currently located in King County for the purpose of constructing the project commonly known as the Southeast Redmond Storage Tank, which property is more particularly described on Exhibit A attached hereto and incorporated herein by this referenced as if set forth in full, and

WHEREAS, by previous ordinance, the City has established proposed zoning regulations and a proposed zoning classification for the Southeast Redmond Storage Tank site of Light Industry (LI), and

WHEREAS, the City now desires to annex the Southeast Redmond Storage Tank site for municipal purposes as provided in RCW 35A.14.300, NOW, THEREFORE,

THE CITY COUNCIL OF THE CITY OF REDMOND, WASHINGTON, DO
ORDAIN AS FOLLOWS:

Section 1. Annexation for Municipal Purposes. That certain property commonly known as the Southeast Redmond Storage Tank site and legally described on Exhibit A attached hereto and incorporated herein by this reference as if set forth in full, is hereby annexed to, and made a part of, the City of Redmond. This

annexation is declared to be for the municipal purposes of using the site for a water storage tank and for future extension of Northeast 65th Street.

Section 2. Zoning. As provided by previous ordinance establishing proposed zoning regulations and a proposed zoning designation for the property pursuant to RCW 35A.14.330 and .340, the official zoning map of the City shall be amended upon annexation of the property described on Exhibit A to designate the same Light Industry (LI).

Section 3. Boundary Review Board. The Mayor is hereby authorized to submit the required Notice of Intent to annex and any other required documentation to the Washington State Boundary Review Board for King County in order to obtain approval for the annexation which is the subject of this ordinance.

Section 4. Other Actions. Upon annexation, the Mayor and City Clerk are authorized to file all necessary annexation certificates and to make all appropriate notifications and filings with King County and the State of Washington in order to finalize the change in City boundaries.

Section 5. Effective Date. This ordinance, being the exercise of a power specifically delegated to the legislative body of the City by RCW 35A.14.300, is not subject to referendum, and shall take effect and be in full force five (5) days after its passage and publication of the attached summary, which is hereby approved, provided, that the annexation shall take effect only upon completion of any necessary review by the Boundary Review Board.

CITY OF REDMOND

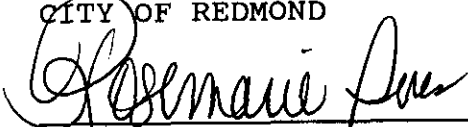
MAYOR ROSEMARIE IVES

ATTEST/AUTHENTICATED:

CITY CLERK, DORIS SCHAIBLE

APPROVED AS TO FORM:
OFFICE OF THE CITY ATTORNEY:

By: 

| | |
|-----------------------------|---------|
| FILED WITH THE CITY CLERK: | 1/13/94 |
| PASSED BY THE CITY COUNCIL: | 1/18/94 |
| SIGNED BY THE MAYOR: | 1/18/94 |
| PUBLISHED: | 1/23/94 |
| EFFECTIVE DATE: | 1/28/94 |
| ORDINANCE NO. _____ | 1766 |

EXHIBIT A

Ordinance No. 1766

Page 1 of 2

Legal Description for Parcel "A", SE Redmond Reservoir Annexation

A parcel of land lying within the southeast quarter of the southwest quarter of Section 7, Township 25 North, Range 6 East, Willamette Meridian, lying within King County, Washington and being more particularly described as follows:

Beginning at the southwest corner of the Cadman Gravel Company Binding Site Plan as recorded under volume 130 of plats, pages 97-100, records of said King County, thence North $00^{\circ}17'43''$ East, 167.03 feet, to the southerly right-of-way line of James Campbell Road, as surveyed under Survey No. 2712, Volume 396A, records of said County, to a point on the Redmond City Limits, thence along the Redmond City Limits South $89^{\circ}14'17''$ East, 49.12 feet, along said right-of-way line, to a point of curvature; thence along said curve, having a radius length of 316.48 feet, a central angle of $31^{\circ}06'38''$ to the left, an arc distance of 171.84 feet; thence leaving said southerly right-of-way line and Redmond City Limits South $00^{\circ}17'43''$ West, 45.52 feet; thence continuing South $00^{\circ}17'43''$ West, 167.07 feet, to the South line of said Binding Plan, thence North $89^{\circ}13'43''$ West, 102.74 feet, to a point on said Redmond City Limits, thence along Redmond City Limits North $89^{\circ}13'43''$ West, 110.27 feet to the Point of Beginning.

Containing an area of 37,995 square feet, more or less.

Prepared by Larry Kendrick / EQR

Date 3-25-92

Checked by Jerry G. Morris

Date 3/25/92

cc/dept dsk01\survey\redmond.ab



Legal Description for Parcel "B", SE Redmond Reservoir Annexation

A parcel of land lying within the southeast quarter of the southwest quarter of Section 7, Township 25 North, Range 6 East, Willamette Meridian, lying within King County, Washington and being more particularly described as follows:

Beginning at the southwest corner of the Cadman Gravel Company Binding Site Plan as recorded under volume 130 of plats, pages 97-100, records of said King County, said corner being located on Redmond City Limits, thence along the Redmond City Limits North $89^{\circ}13'44''$ West, 3.36 feet, along the South line of the North 200 feet of the East half of the southeast quarter of the southwest quarter of said Section 7 to the West line of said subdivision point being the southwest corner of a tract of conveyed to Redmond Sportman Assoc., Inc., by deed recorded under Auditor's No. 2647686, records of said King County; thence North $00^{\circ}25'53''$ East, 167.03 feet, along said West line as shown under Record of Survey filed under Volume 74, page 049, of said King County, to the southerly right-of-way line of James Campbell Road, as surveyed under Survey No. 2712, Volume 396A, records of said County; thence South $89^{\circ}14'17''$ East, 2.96 feet, along said southerly right-of-way line to the West line of said Cadman Gravel Company Binding Site Plan; thence leaving said right-of-way and City Limits South $00^{\circ}17'43''$ West, 167.03 feet along said West line to the Point of Beginning.

Containing an area of 528 square feet, more or less.

Prepared by Larry Kudrlich / EAR

Date 3-25-92

Checked by Jerry G. Morris

Date 3/25/92

ee/dept dsk01\survey\redmond.ab

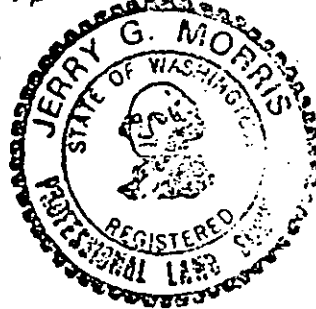

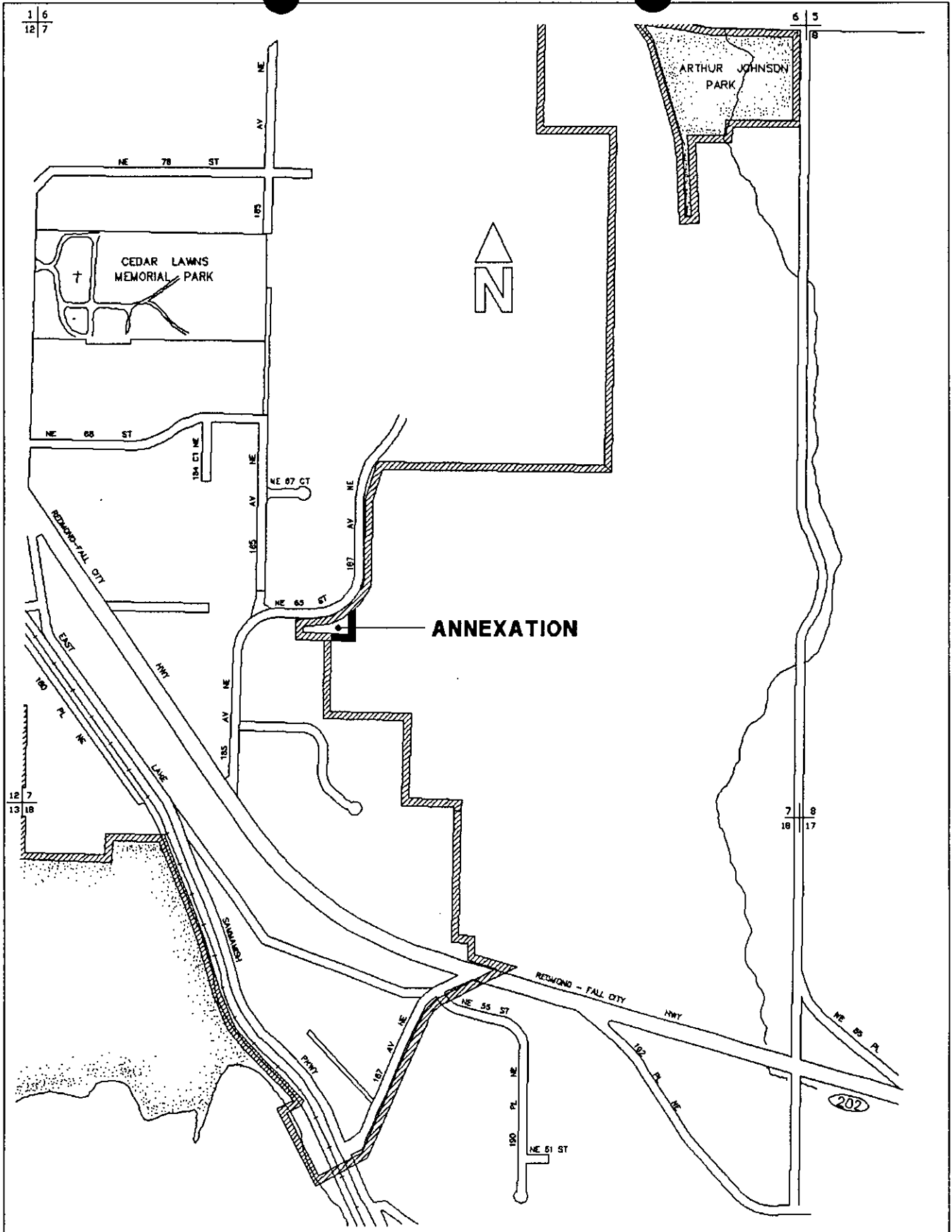

VICINITY MAP

ANN-91-0003